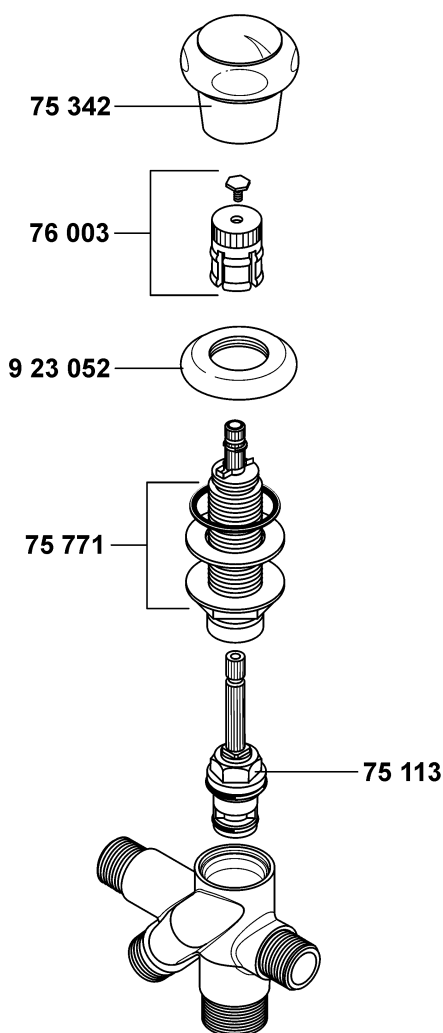

53848

A_5384821

53848
Zwei-Wege-Umstellung DN 15
two way diverter DN 15
2-weg omstelling 1/2"

75 113 Oberteil
75 342 Griff KLUDI PAMELA
75 771 Befestigungssatz
76 003 Griffbefestigung
923 052 Rosette

upper valve diameter
handle KLUDI PAMELA
assembling set
fastening set for handle
wall flange

bovendeel
greep KLUDI PAMELA
bevestigingsset
greepbevestiging
rozet